

20th - 23rd Feb 2025 (3 Nights from 20:00hrs-06:00hrs)

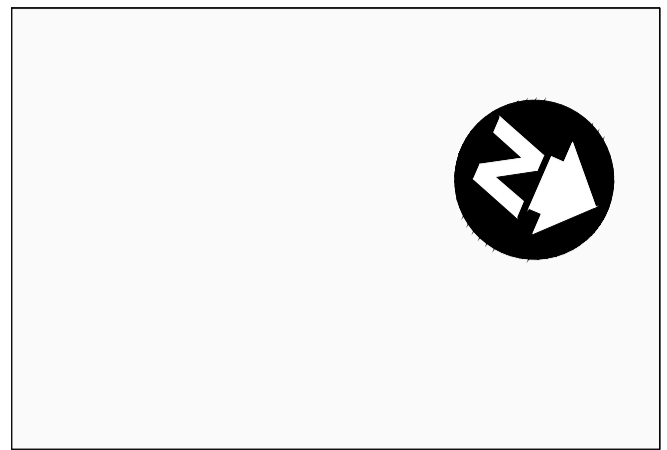

Advance signing posting for lane denial
 Recommendation to have near-side sign posting only, to eliminate carriageway crossing

Advance signing posting for lane closure
 Recommendation to have near-side sign posting only, to eliminate carriageway crossing

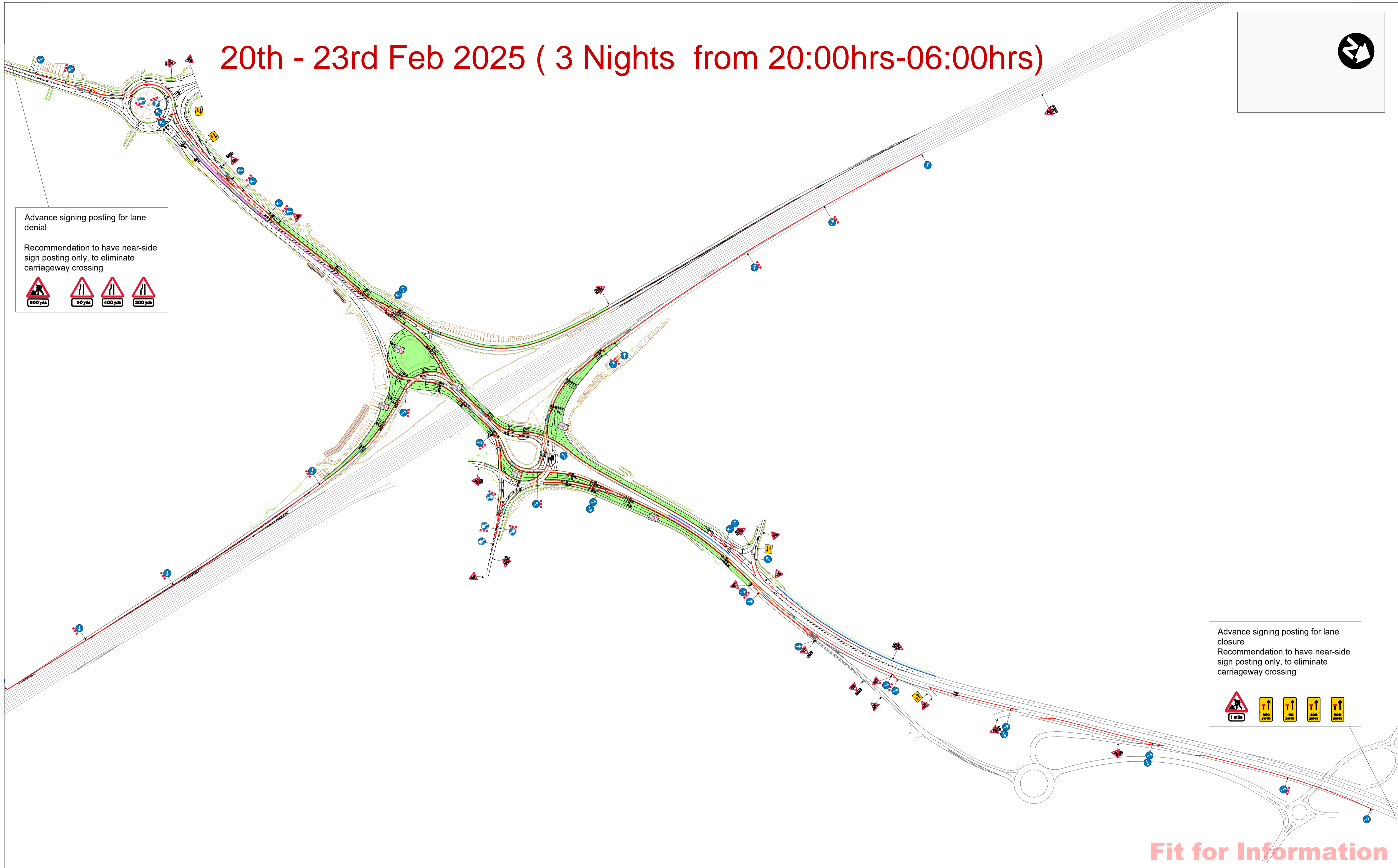

Fit for Information

Rev	Description	Drawn	Checked	Approved	Con App
P01	First Issue	---	---	---	---
P02		---	---	---	---
P03		---	---	---	---
P04		---	---	---	---
C01		---	---	---	---

Additional notes:
 Any Technical Notes including barrier specification and measurements are permitted to appear in the paper space.
 Any other Notes should be annotated within this space using the following standard:
 Note 1:
 Note 2:

Key:
 Traffic Cone
 Work Area



Project/Contract		M1 Jct 15		
Zone	M1 Jct 15	Drawn	Checked	Approved
		PW	EM	EM
Drawing Title	Temporary overnight ring management	Date	Scale	Size
	Phase 2	14/01/25	NTS	A1
	---	Technical Design Status	Project Stage	Suitability
	---	NA	NA	S02
		Drawing No.		Rev.
		M1JCT15-EMV-TTM-000-DR-CW-00005		P01

This document is issued for the party which commissioned it and for specific purposes connected with the captioned project only. It should not be relied upon by any other party or used for any other purpose. EMVIA accepts no responsibility for the consequences of this document being relied upon by any other party, or being used for any other purpose, or containing any error or omission which is due to an error or omission in data supplied to Virtus by other parties.

EMVIA Ltd accepts no responsibility for any circumstances which arise from the reproduction of this document after any revisions, alterations or amendments are made, or if it is issued in part or issued incompletely in any way.